



FALKBRIS

NAME OF SHIP	MV FALKBRIS
CALL SIGNAL	LAJB8
PORT OF REG.FLAG	STAVANGER
TYPE OF VESSEL	DRY CARGO SHIP
BUILT	GERMANY, 1992
OWNER	FALKEID SHIPPING AS NO-4160 FINNØY
OFFICIAL NUMBER	9006291
IMO NUMBER	9006291
MMSI	248 216 000
CLASS & NUMBER	GL 100 AS EG + MC E Aut. / No 33304
LENGTH OVERALL	87.83 m
LENGTH B.P.	81.00 m
BEAM EXTREME	12.82 m
DRAUGHT SUM./WIN.	5.468 m / 5.353 m
FREE BOARD SUM./WIN.	1.445 m / 1.560 m
MOULDED DEPTH	7.10 m
AIR DRAFT	24.00 m
DEADWEIGHT SUM./WIN.	3.475 mt / 3.359 mt
LIGHT SHIP	1.420.4 mt
GROSS TONNAGE	2449 mt
NET TONNAGE	1380 mt
MAIN ENGINE	DEUTZ 1500 kw / 2040 HP
PROPELLER	One Right Handed fixed Propeller
BOW THRUSTER	184 kw / 250 HP
RUDDER TYPE	BECKER

TOTAL BALLAST	1641.9 m ³ / 14 TANKS
TOTAL FRESH WATER	56.6 m ³ / 4 TANKS
TOTAL MAR. DIESEL OIL	122.8 m ³ / 5 TANKS
TOTAL LUB.OIL	9.2 m ³ / 2TANKS
SLUDGE CAP.	4.6 m ³
BILGE WATER apox. CAP.	6.0 m ³
DIRTY OIL CAP.	8.8 m ³
HOLD/Type/Size of hatch cover	BOXSHAPED-TYPE / 56 60 m + 10 20 m
HOLD DIMENSION / L+B+H	56 60 m + 10 20 m + 8 19 m
HOLD CAPACITY Grain / Bales	4666/4635 m ³ / 166642/165536 sft.
MAX.LOAD ON DECK / H. COVER	15 t/m ² / 1,53 t/m ²
LENGTH OF ANCHOR CHAIN	PORT/STBD - 7 SHACKLES + 27 1 m each

Contact details:
 Mobile: +47 966 13 437
 Email: falkbris@falkeid.no

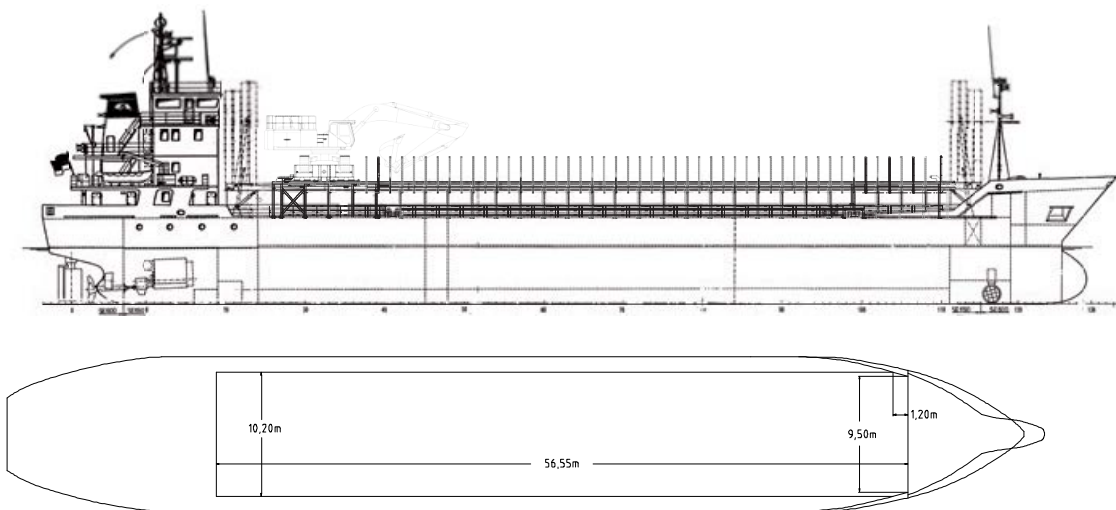

All details are without guarantee